

**PLAN VIEW**

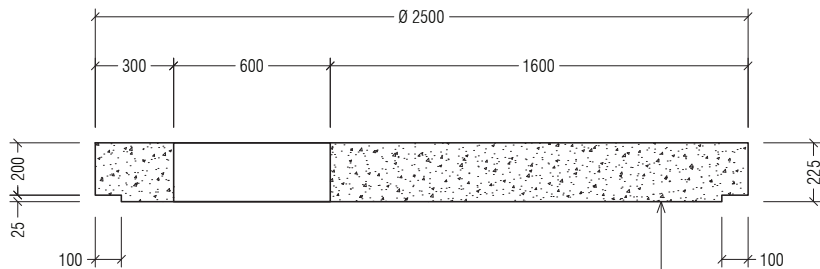

**SECTION A-A (LID)**

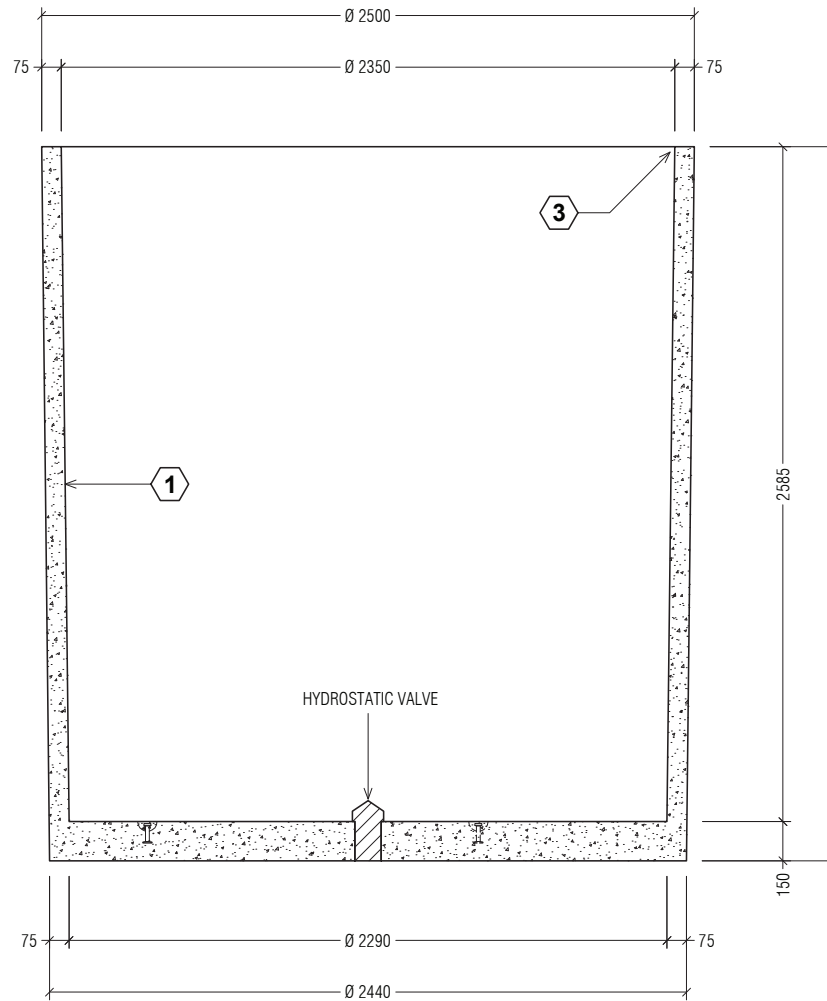

**SECTION A-A (TANK)**

**CLASS RATING :**  
EXTRA HEAVY DUTY

**LIVE LOAD LIMITS :**  
T44 LOADING

**DEAD LOAD**  
0 TO 1200 mm OF FILL

**CONCRETE GRADE :**  
CONCRETE STRENGTH 50 MPa  
EXPOSURE CLASSIFICATION B1  
AS 3600-2001  
25 mm MIN COVER TO REO

**TOTAL MASS :**  
**LID :**  
CONCRETE VOL = 1.023 m<sup>3</sup>  
MASS OF LID = 2560 Kg

**TANK :**  
CONCRETE VOL = 2.178 m<sup>3</sup>  
MASS OF TANK = 5460 Kg

**LIFTING :**  
**LID & BASE :**  
3 No. 2.5 TONNE x 90 LONG  
REID SWIFTLIFT FOOT ANCHORS

**NOTES :**  
BEARING CAPACITY OF SOIL  
UNDER THE TANK TO BE  
150 kPa MINIMUM



Quality  
ISO 9001



**TANKET**  
Cnr Bayfield Rd East & Canterbury Rd,  
Bayswater North 3153 Vic Australia  
T: 1300 826 538 www.tanket.com.au

**11,000 Litre Concrete Tank  
Extra Heavy Duty**

No.	ITEM CODE	QTY	DESCRIPTION
1	565V11000BXHD	1	11,000 CONCRETE TANK BASE - XHD
2	565V11000LXHD	1	11,000 CONCRETE TANK LID - XHD
3	VMASTIC25	3	BOSTIC 25 mm MASTIC

No.	DATE	REVISIONS
A	26.11.14	FIRST ISSUE

SCALE	DATE	DRG No.	REV
-	26.11.14	565V11000XHD	A
DRAWN	R.P.	CHECKED	D. EGAN
SIZE	A3		