

COVER DETAIL

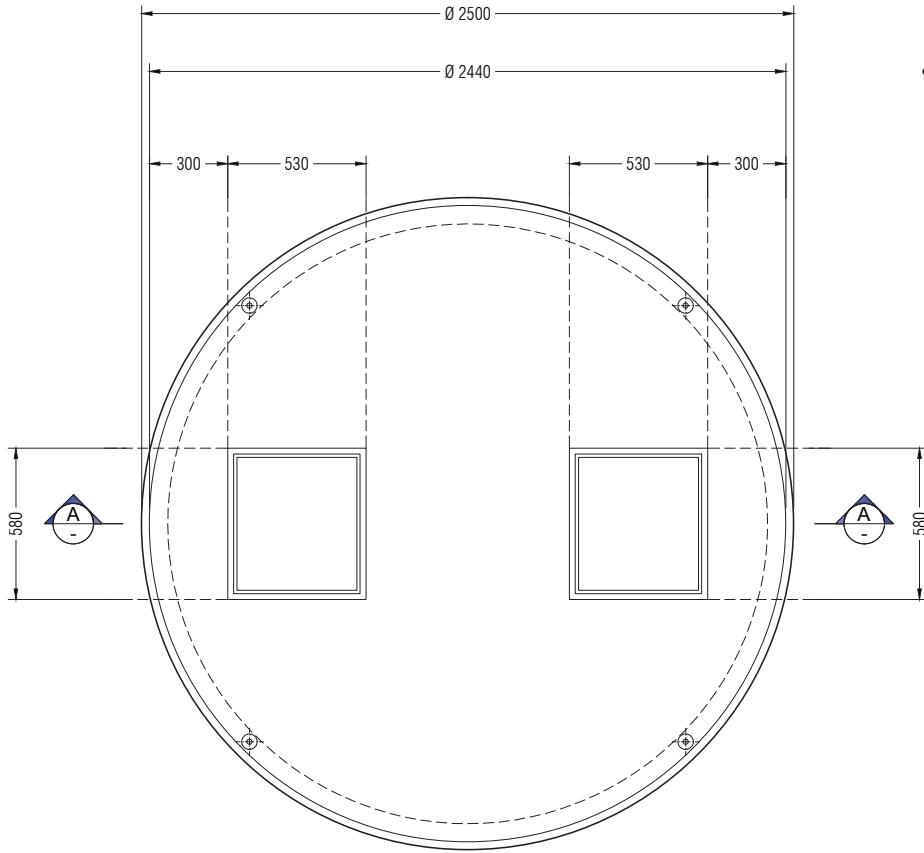

PLAN VIEW

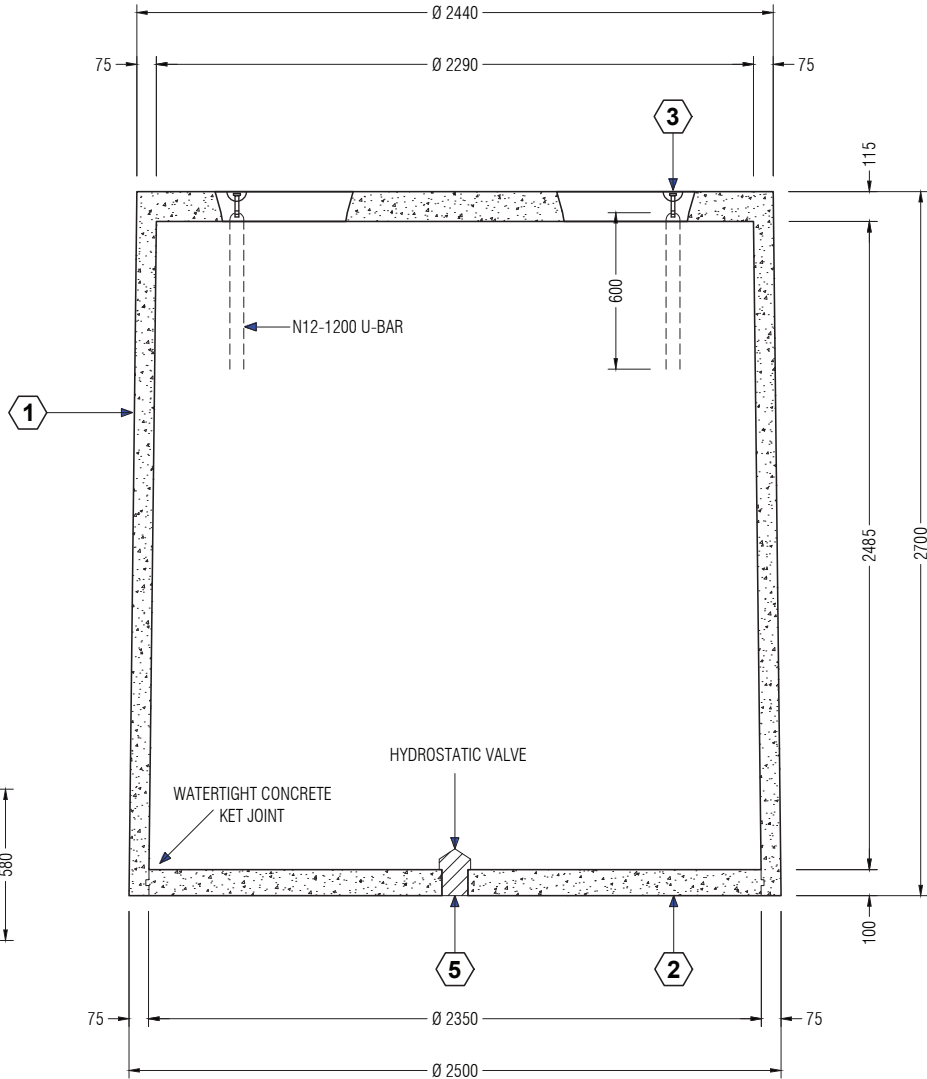

SECTION A-A (TANK)

CLASS RATING :

STANDARD DUTY

LIVE LOAD MASS LIMITS :

MAXIMUM = 0.5T GVM

DEAD LOAD :

0 TO 1.0 m OF FILL

CONCRETE GRADE :

CONCRETE STRENGTH 40 MPa
EXPOSURE CLASSIFICATION B1
AS 3600-2001

TOTAL MASS :

6.000 TONNES

LIFTING :

4 x 2.5T SWIFTLIFT EYE ANCHORS
(2REA070)

NOTES :

BEARING CAPACITY OF SOIL
UNDER THE TANK TO BE
150KPa MINIMUM



Quality
ISO 9001



TANKET

Cnr Bayfield Rd East & Canterbury Rd,
Bayswater North 3153 Vic Australia
T: 1300 826 538 www.tanket.com.au



TITLE
**10,500 Litre Concrete Tank
Standard Duty**

No.	ITEM CODE	QTY	DESCRIPTION
1	565V10500TSD	1	10,500 CONCRETE TANK TOP - SD
2	565V10500BSD	1	10,500 CONCRETE TANK BASE - SD
3	2REA070	4	COMBINATION ANCHOR - 2.5T x 70 mm
4	600V006	2	SQUARE MANHOLE COVER
5	605A110	1	HYDROSTATIC VALVE

No.	DATE	REVISIONS
A	07.10.14	FIRST ISSUE

SCALE	DRG No.	REV
-	565V10500SD	A
DATE	CHECKED	D. EGAN
07.10.14		
DRAWN	R.P.	SIZE
		A3